

Crankshaft Pulley

Removal

1. Disconnect battery ground cable.
2. Remove air cleaner assembly.

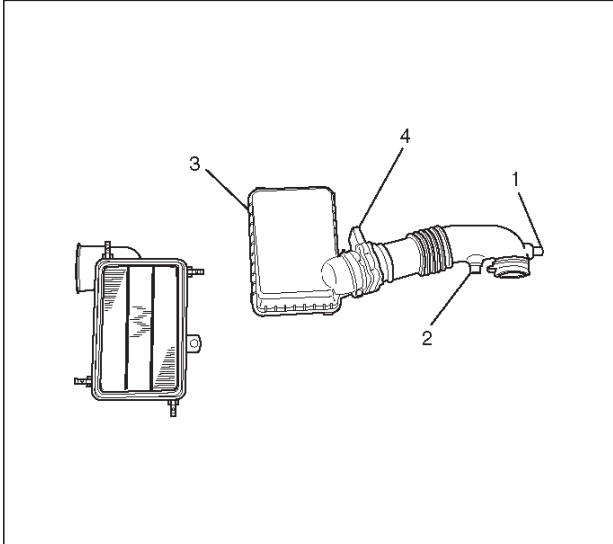

013RY0001

Legend

- (1) Positive Crankcase Ventilation Hose Connector
- (2) Intake Air Temperature Sensor
- (3) Air Cleaner Duct Assembly
- (4) Air Flow Sensor

3. Remove radiator upper fan shroud from radiator.
4. Move serpentine belt tensioner to loose side using wrench then remove serpentine belt.

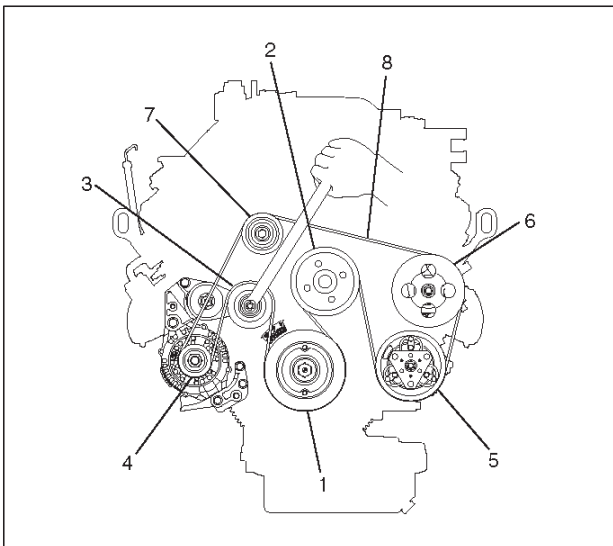

850RW001

Legend

- (1) Crankshaft Pulley
- (2) Cooling Fan Pulley
- (3) Tensioner
- (4) Generator
- (5) Air Conditioner Compressor
- (6) Power Steering Oil Pump
- (7) Idle Pulley
- (8) Driver Belt

5. Remove cooling fan assembly four fixing nuts, then the cooling fan assembly.
6. Remove crankshaft pulley assembly using J-8614-01 crankshaft holder, hold crankshaft pulley then remove center bolt and pulley.

Installation

1. Install crankshaft pulley using J-8614-01 crankshaft holder, hold the crankshaft pulley and tighten center bolt to the specified torque.

Torque : 167 N·m (123 lb ft)

2. Install cooling fan assembly and tighten bolts/nuts to the specified torque.

Torque : 22 N·m (16 lb ft) for fan pulley and fan bracket.

Torque : 7.5 N·m (66.4 lb in) for fan and clutch assembly.

3. Move serpentine belt tensioner to loose side using wrench, then install serpentine belt to normal position.
4. Install radiator upper fan shroud.
5. Install air cleaner assembly.